

2-Row Spray Rig Recommendation

Caleb Fink and Andrew Molinar

Our recommended manifold design is **8 nozzles** per bed, spraying at a pressure of **100 psi**. The recommended nozzle is **TeeJet Even Flat Spray Tip TP8003EVS Blue** with an even flat fan pattern. We evaluated this manifold design at a rate of **133 gpa** and tractor speed of **3.2 mph**. The evaluation consisted of 568 water-sensitive spray cards to evaluate number of nozzles, nozzle type, and manifold design. Please note: proper maintenance, calibration, and spraying at canopy level ensures improved distribution uniformity and overall spray coverage.

2-Row Manifold Design

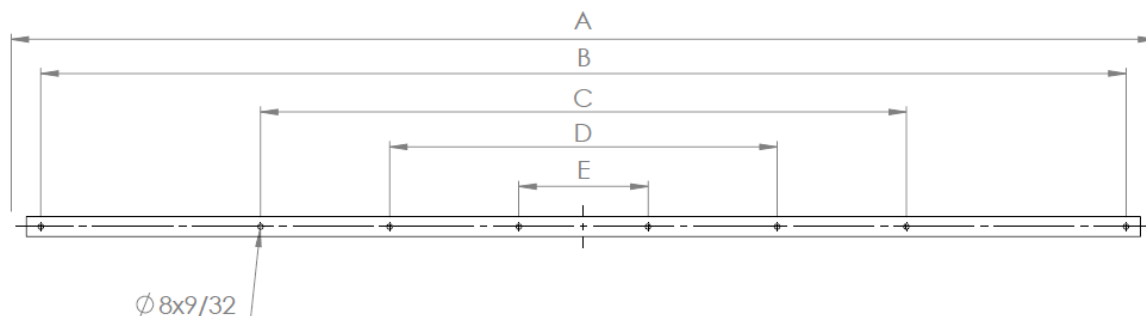

	Plant Row Spacing 12	Plant Row Spacing 16
Bed Center - Center	48 or 52	48 or 52
A	48 or 52	48 or 52
B	41	45
C	22-1/2	26-1/2
D	12	16
E	5-1/4	5-1/4

All Dimensions in inches

Recommended 2-Row Manifold Design Diagram

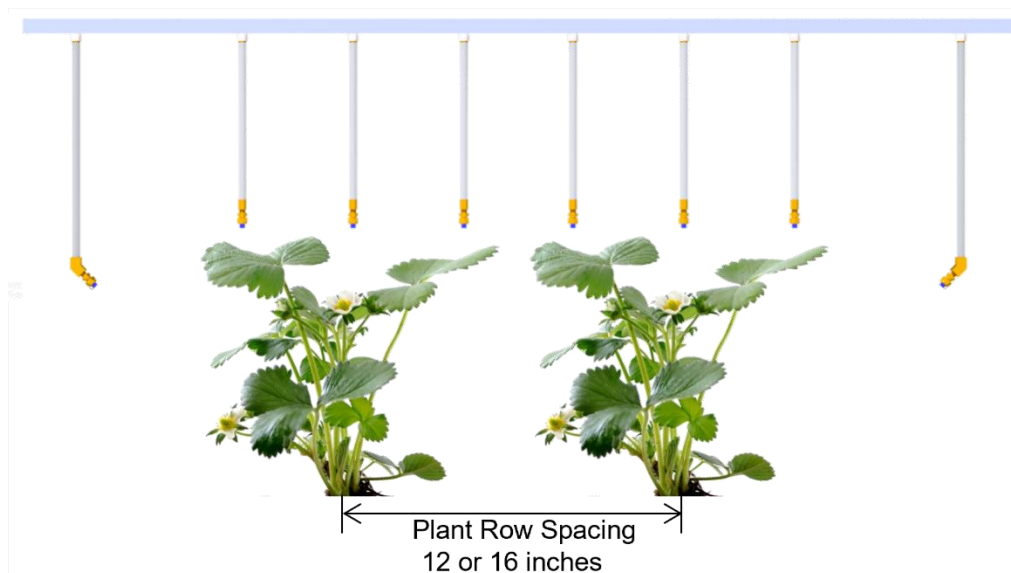

Caleb Fink
California Strawberry Commission
805.471.2278
cfink@calstrawberry.org

Andrew Molinar
California Strawberry Commission
805.340.8373
amolinar@calstrawberry.org



4-Row Spray Rig Recommendation

Our recommended manifold design for 4-row beds is **8 nozzles** per bed, spraying at a pressure of **108 psi**. The recommended nozzle is **TeeJet ConeJet Green TXR80036VK** or an **Albuz ATR80 Green** with a hollowcone spray pattern. We evaluated this manifold design at a rate of **150 gpa** and tractor speed of **2.9 mph**. The evaluation consisted of 1,716 water-sensitive spray cards to evaluate pressure, number of nozzles, and nozzle type. Please note: proper maintenance, calibration, and spraying at canopy level ensures improved distribution uniformity and overall spray coverage.

2-Row Manifold Design

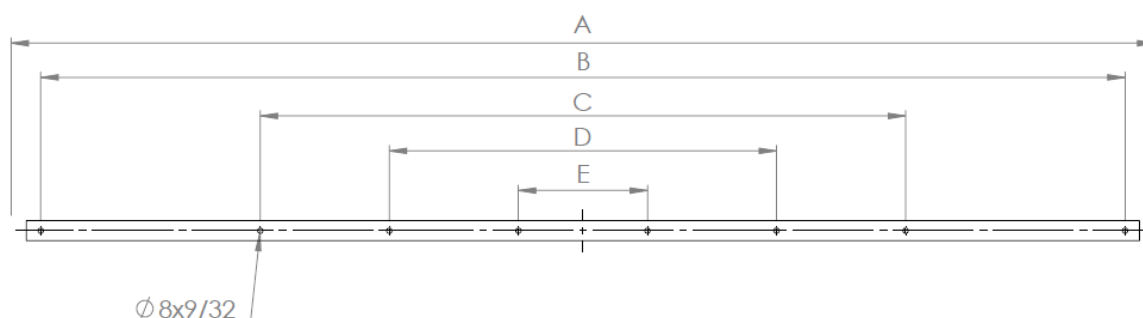

	Santa Maria 4-row	Oxnard 4-row
Bed Center - Center	64	68
A	58	64
B	56-7/8	60-7/8
C	33-7/8	38
D	20-1/4	22-3/4
E	6-3/4	7-1/2

All Dimensions in inches

Spray Rig with Recommended 4-Row Manifold Design

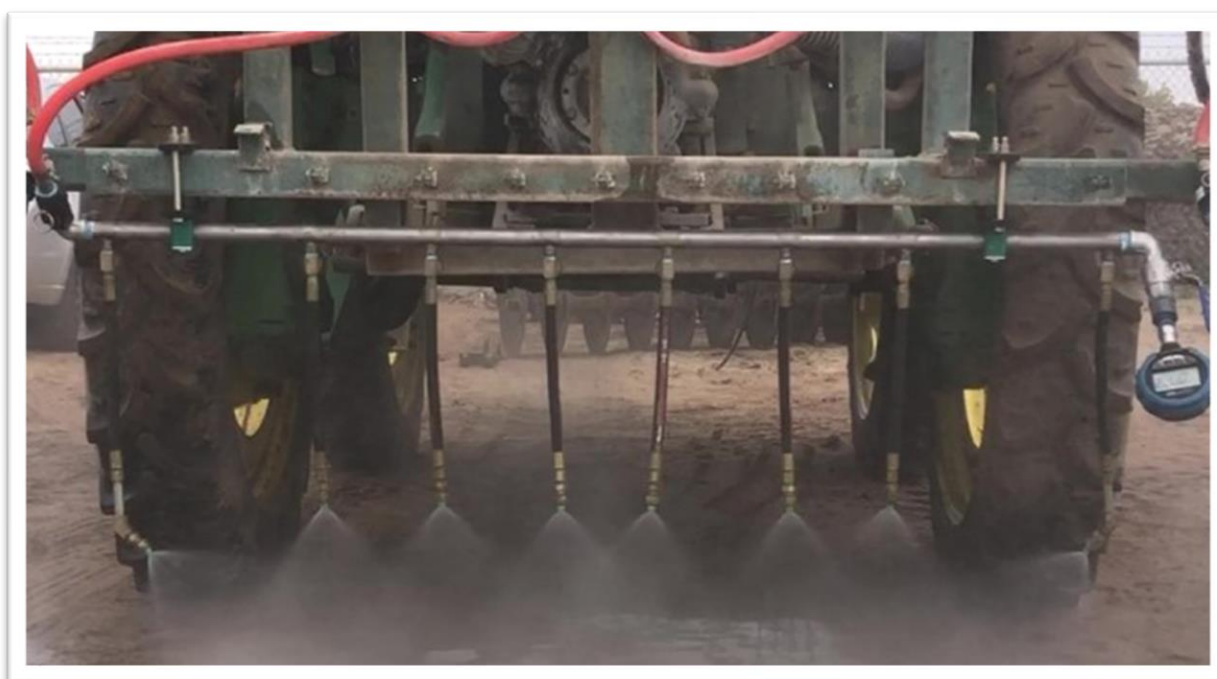

Caleb Fink
California Strawberry Commission
805.471.2278
cfink@calstrawberry.org

Andrew Molinar
California Strawberry Commission
805.340.8373
amolinar@calstrawberry.org