

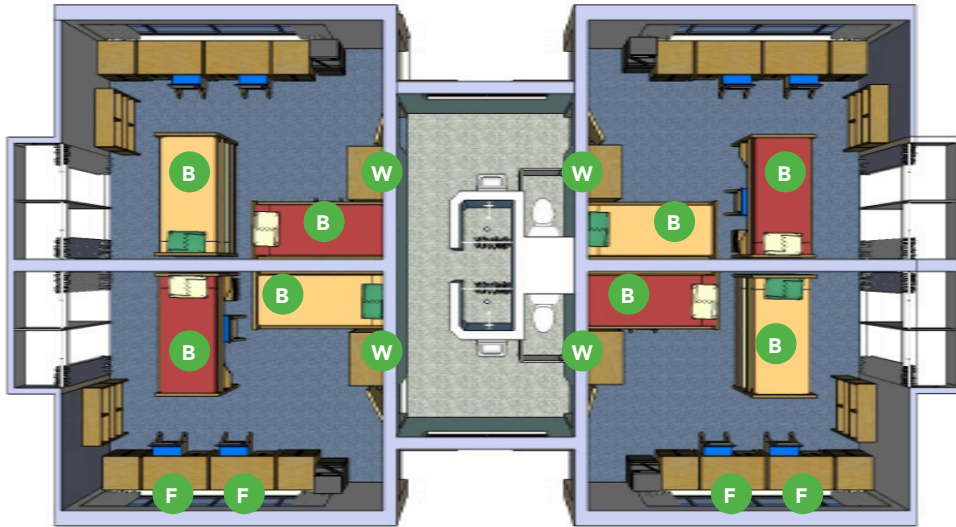

12-Person Mid Quad

(In some rooms dresser, is underneath bed)



12-Person End Quad

(In some rooms, dresser is underneath bed)



CHARGES WILL BE APPLIED IF FURNITURE IS NOT RETURNED TO ITS ORIGINAL LOCATION

- W** Wardrobe
- B** Bed
- D** Dresser(s)
- F** Desk, File Cabinet, Chair

*Note: Although these room layouts are typical, there may be some that don't match these exact configuration. Do not block doors, closets or windows with furniture. Mini-fridges should be left on floor (not on furniture) and be plugged directly into the wall (not surge protector).*