



*Connected Teams.
Bold Solutions.*

Structural Engineering Design Engineer Positions and Summer Internships

Seattle | Tacoma | Portland

**Develop your career in a supportive,
collaborative environment.**

PCS Structural Solutions offers careers in structural engineering with incredible mentorship opportunities, engaging firm culture and excellent benefits. With offices in Seattle, Tacoma, and Portland, we work with award-winning project teams to design buildings across the country. We have full-time positions and internship opportunities available now.

Visit pcs-structural.com/careers for more information.



Explore Your Career in Structural Engineering!

- Senior year or Master's degree student working towards a degree in Civil/Structural Engineering from an accredited college or university
- Excellent knowledge of Microsoft Office suite
- Knowledge of Revit is a plus
- Attention to detail
- Willingness to learn and develop your craft alongside a dynamic team

Join Our Team.

To apply for a job or internship, visit
pcs-structural.com/careers

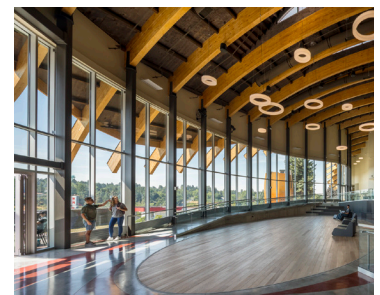

PCS Structural Solutions provides equal employment opportunities (EEO) to all employees and applicants for employment without regard to race, color, religion, sex (including pregnancy, gender identity, and sexual orientation), national origin, age, disability, family medical history or genetic information, military service, or other non-merit based factors. In addition to federal law requirements, PCS Structural Solutions complies with applicable state and local laws governing nondiscrimination in employment in every location in which the company does business. This policy applies to all terms and conditions of employment, including recruiting, hiring, placement, promotion, termination, layoff, recall, transfers, leaves of absence, compensation, and training.